

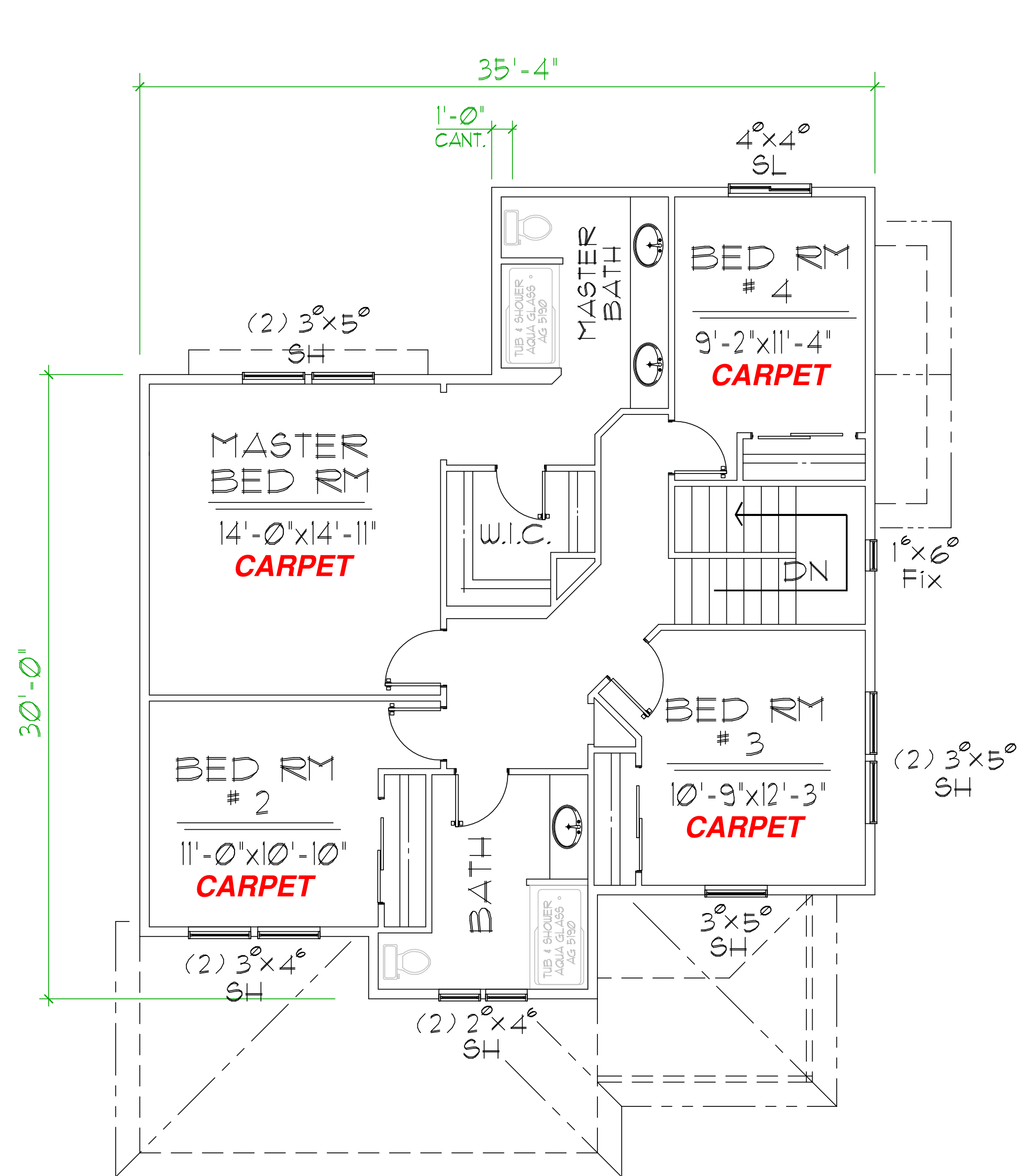

FRONT



RIGHT



2nd FLOOR PLAN

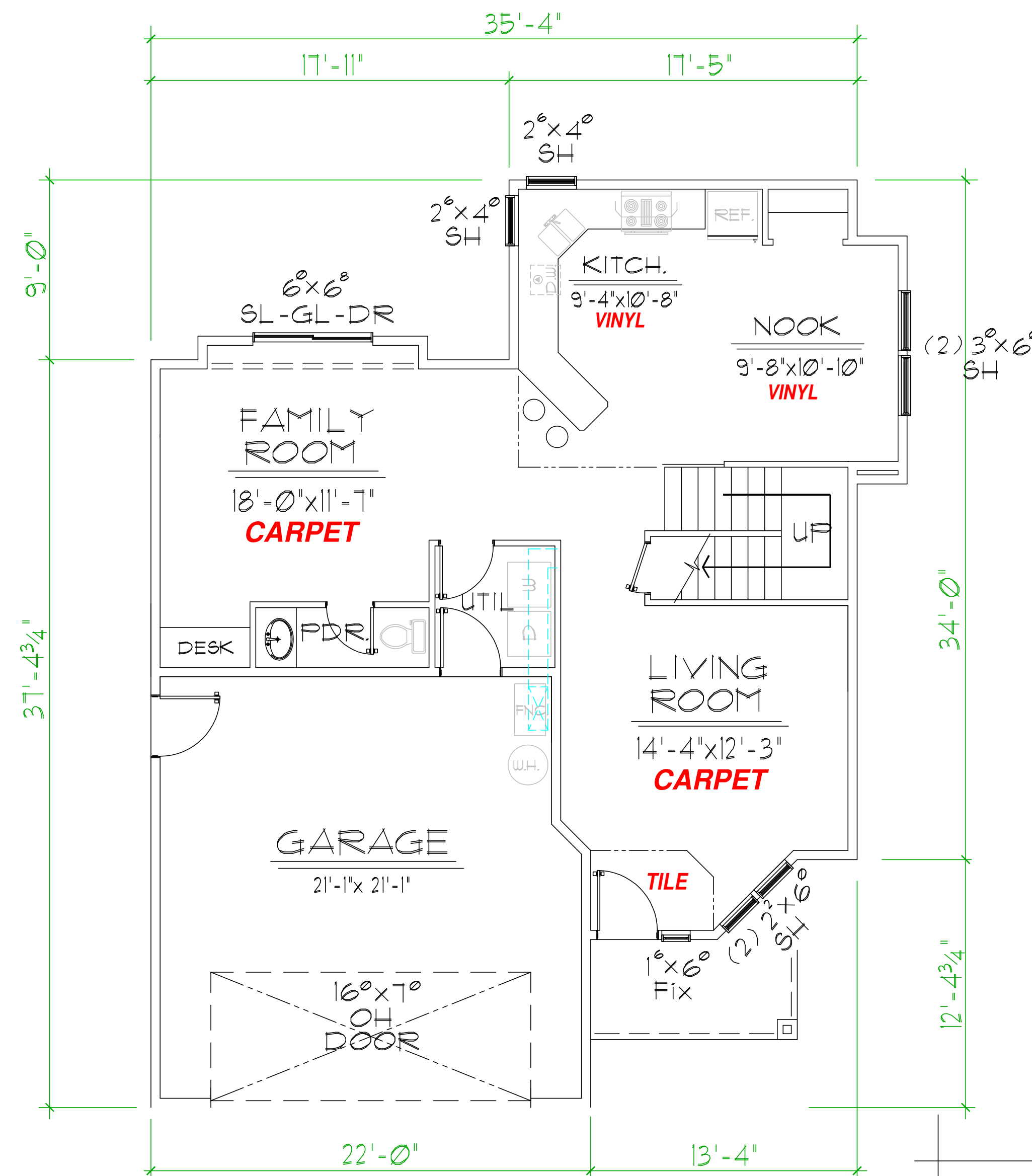

1st FLOOR PLAN

9'-0"
CEILINGS

The Truax Mtn.

PLAN MD-2031

BEDROOMS: 4 BATHS: 2½

1st FLOOR LEVEL	934 SQ. FT
2nd FLOOR LEVEL	1065 SQ. FT
TOTAL LIVING AREA	1999 SQ. FT
GARAGE	456 SQ. FT

EXTERIOR WALL FRAMING 2 x 6

FOUNDATION: crawl space (post & beam)

PEAK HOME DESIGN
P.O. BOX 237
ENTERPRISE, OREGON 97828
ph: (541) 426-4607
E-MAIL: peakhd@bmi.net