

The Chehalem

PLAN PD-1006

BEDROOMS: 3 BATHS: 2

TOTAL LIVING AREA 1351 SQ. FT

GARAGE 469 SQ. FT

EXTERIOR WALL FRAMING 2 x 6

FOUNDATION: crawl space (post & beam)

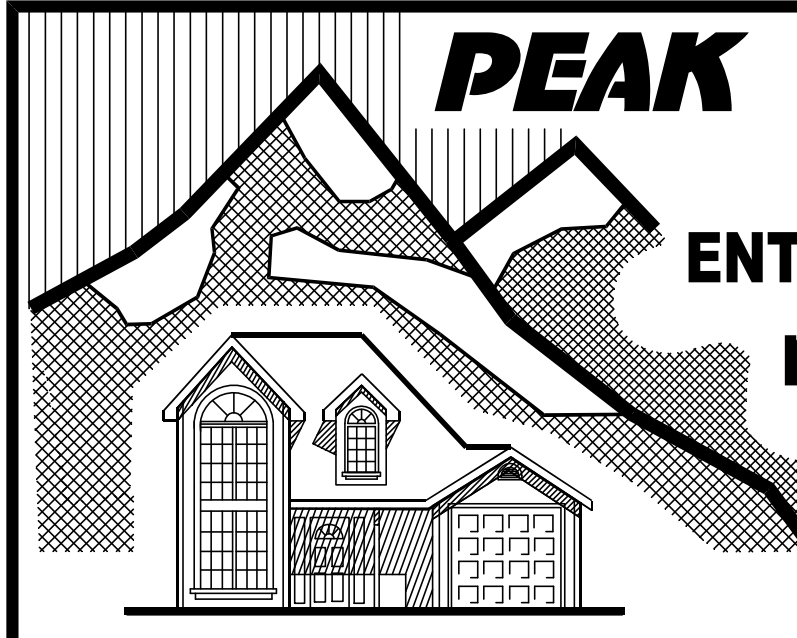

PEAK HOME DESIGN
 P.O. BOX 237
 ENTERPRISE, OREGON 97828
 ph: (541) 426-4607
 E-MAIL: peakhd@bmi.net

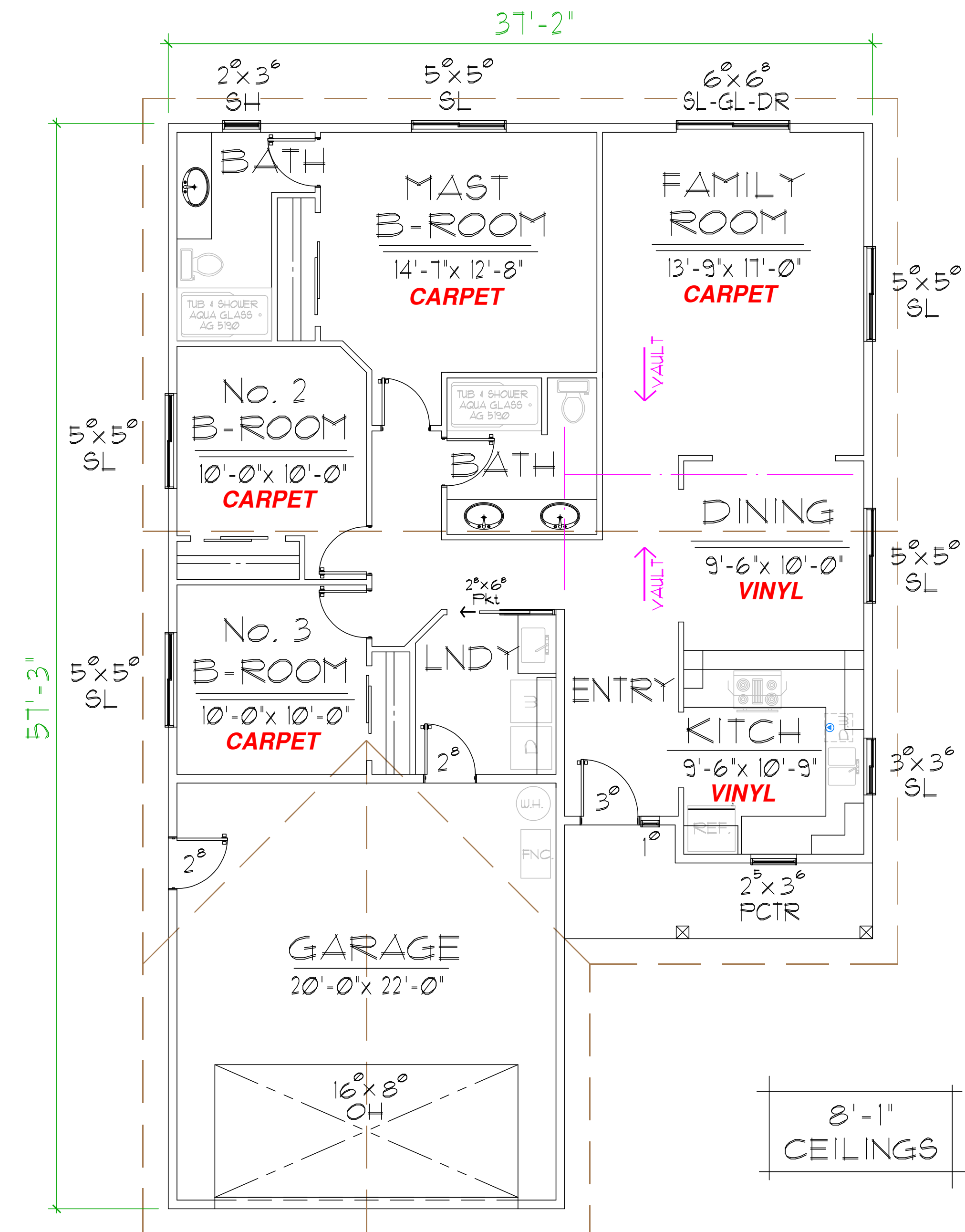

FLOOR PLAN

