

# The Mount Theilsen

PLAN MD-9910

BEDROOMS: 4      BATHS: 3½

1st FLOOR      2121 SQ. FT.  
 2nd FLOOR      1371 SQ. FT.  
 TOTAL LIVING AREA      3498 SQ. FT.

GARAGE      1023 SQ. FT.  
 OPTIONAL STORAGE      169 SQ. FT.

EXTERIOR WALL FRAMING      2 x 6

FOUNDATION: crawl space (joist system)

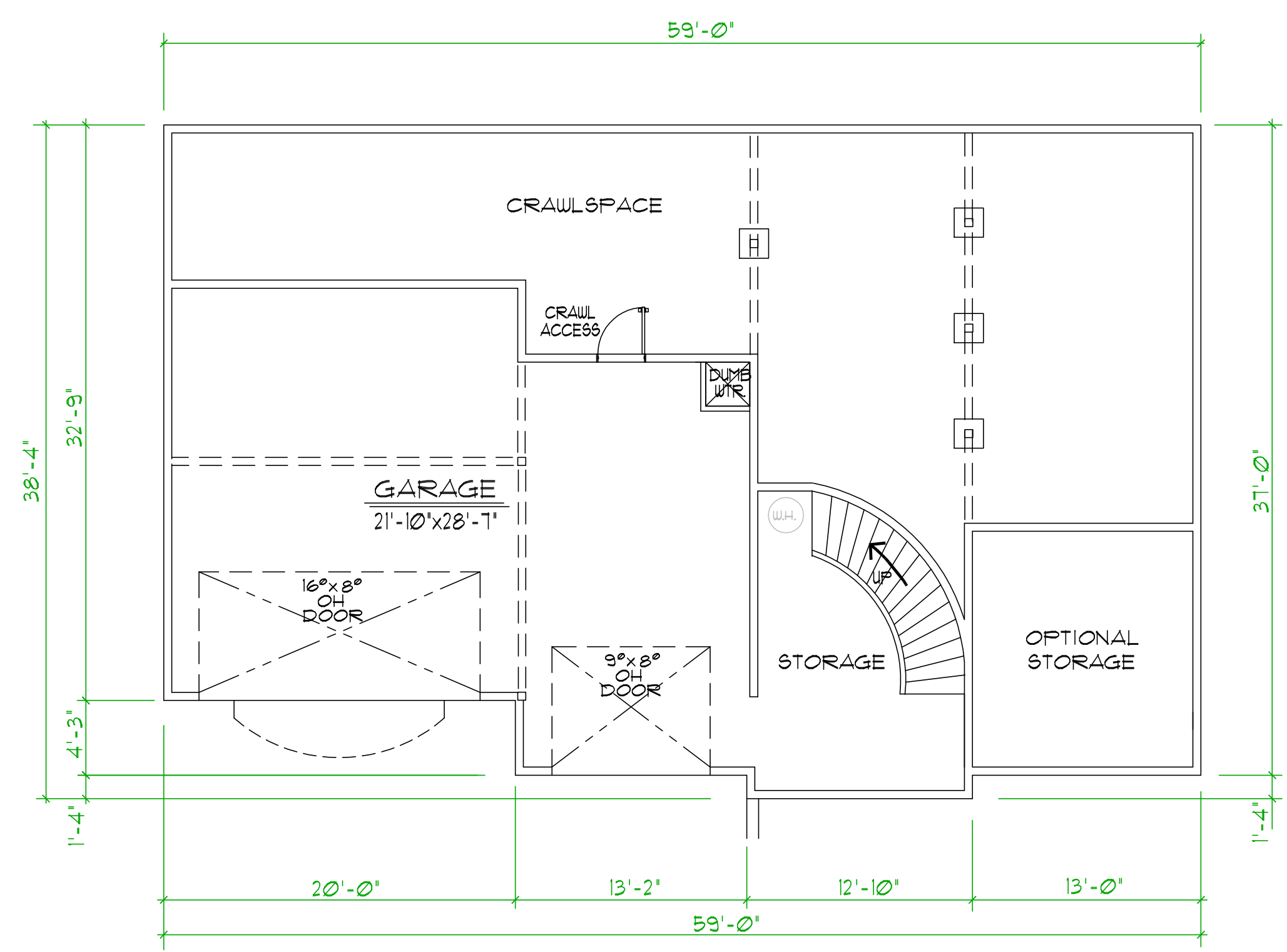
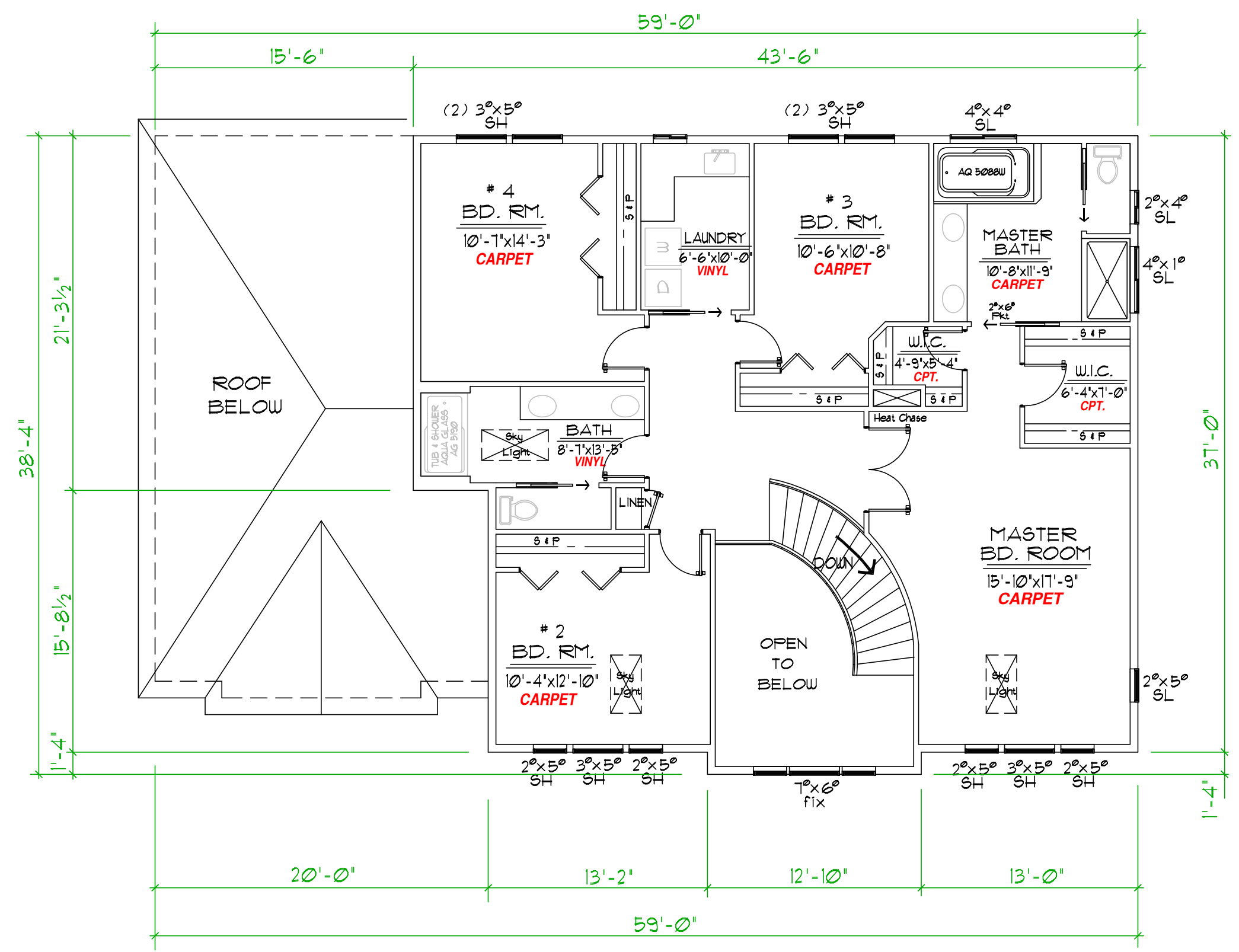

**PEAK HOME DESIGN**  
 P.O. BOX 237  
 ENTERPRISE, OREGON 97828  
 ph: (541) 426-4607  
 E-MAIL: peakhd@bmi.net

