

The Pueblo Mtn.

PLAN MD-2004

BEDROOMS: 5 BATHS: 2 1/2

1st FLOOR	974 SQ. FT
2nd FLOOR	1524 SQ. FT
TOTAL LIVING AREA	2498 SQ. FT
GARAGE	730 SQ. FT

EXTERIOR WALL FRAMING 2 x 6

FOUNDATION: crawl space (post & beam)

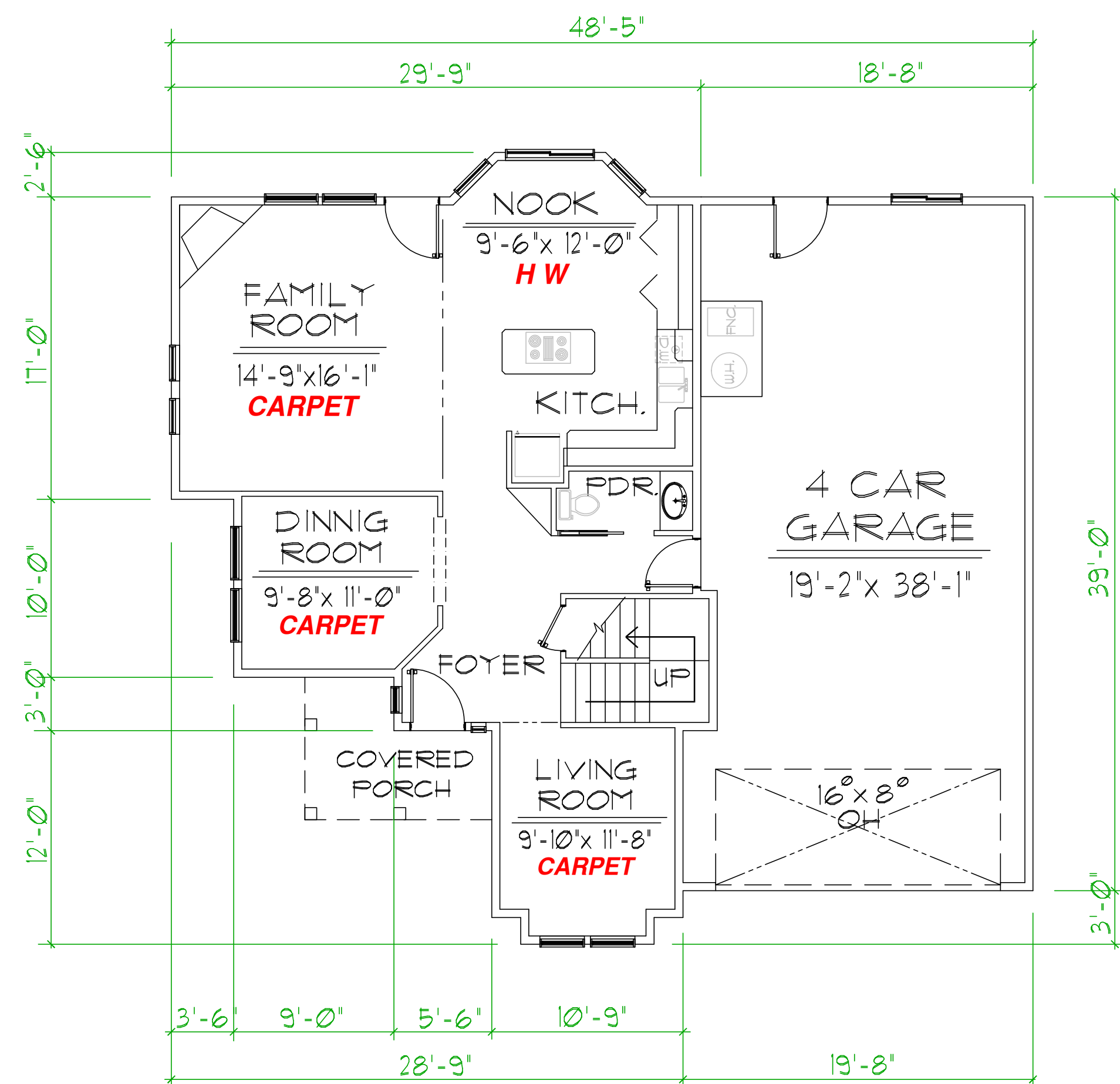

PEAK HOME DESIGN
 P.O. BOX 237
 ENTERPRISE, OREGON 97828
 ph: (541) 426-4607
 E-MAIL: peakhd@bmi.net