

FRONT

The Hurricane Divide

PLAN MD-0229

BEDROOMS: 4 BATHS: 3 1/2

FIRST FLOOR 1440 SQ. FT

SECOND FLOOR 1803 SQ. FT

TOTAL LIVING AREA 3243 SQ. FT

GARAGE 662 SQ. FT

EXTERIOR WALL FRAMING 2 x 6

FOUNDATION: crawl space (post & beam)

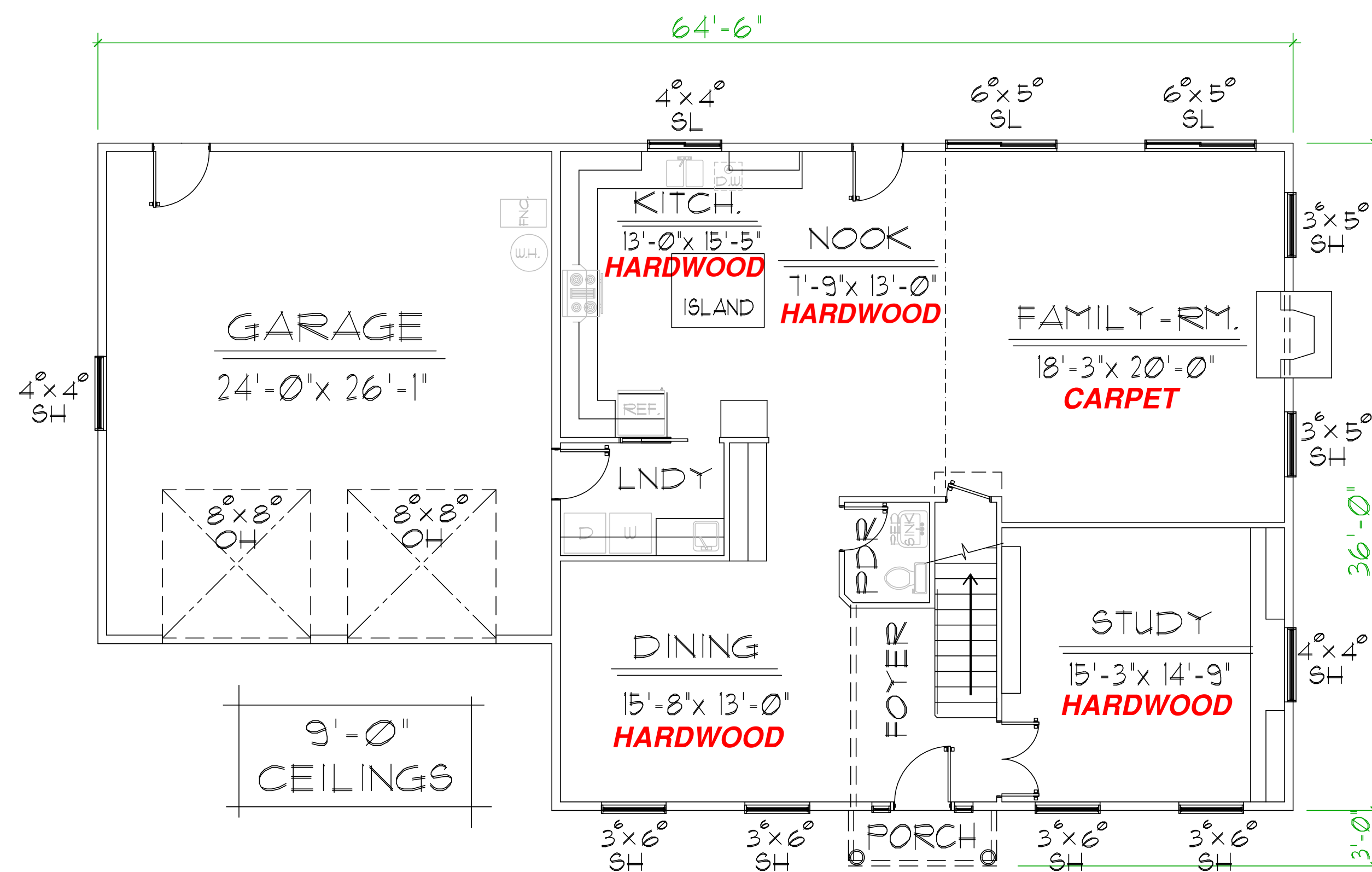

PEAK HOME DESIGN
 P.O. BOX 237
 ENTERPRISE, OREGON 97828
 ph: (541) 426-4607
 E-MAIL: peakhd@bmi.net